

Cottrell Road

EASTVILLE

APPROXIMATE FLOOR AREA
107.8 SQM / 1076 SQFT



GROUND FLOOR
580 sq.ft. (53.9 sq.m.) approx.

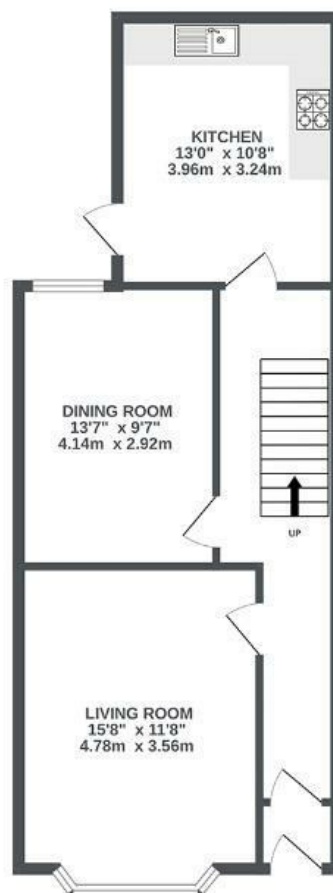

1ST FLOOR
581 sq.ft. (53.9 sq.m.) approx.

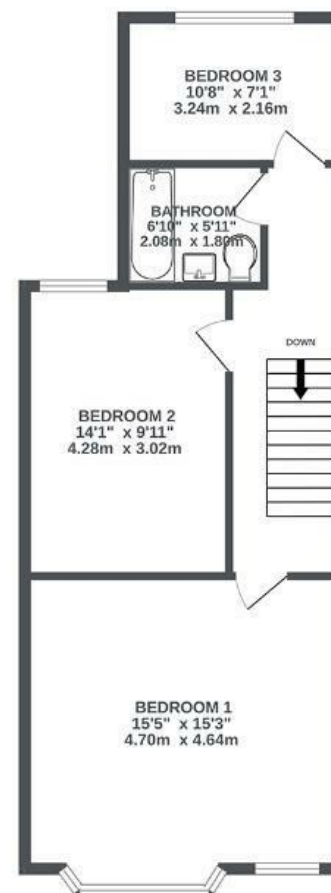

Boardwalk

Cottrell Road, , BRISTOL

£

£380,000



Bristol, BS5
6TH

zzz

3 Bedrooms



1 Bathrooms

"I have loved living here, the seemingly endless dining options with Gloucester Road, Fishponds Road & St Marks Road all nearby along with good schools within easy walking distance. All of this in a strong community where you will always have support and something to take part in!"

